

## How to auto-connect after launch on PureVPN Windows app

With this feature, you now have the security on the go whenever you wish to use public wifi spots or in general a network that you don't trust. Here's how you can proceed.

- Click Settings icon from the left pane of the PureVPN App.

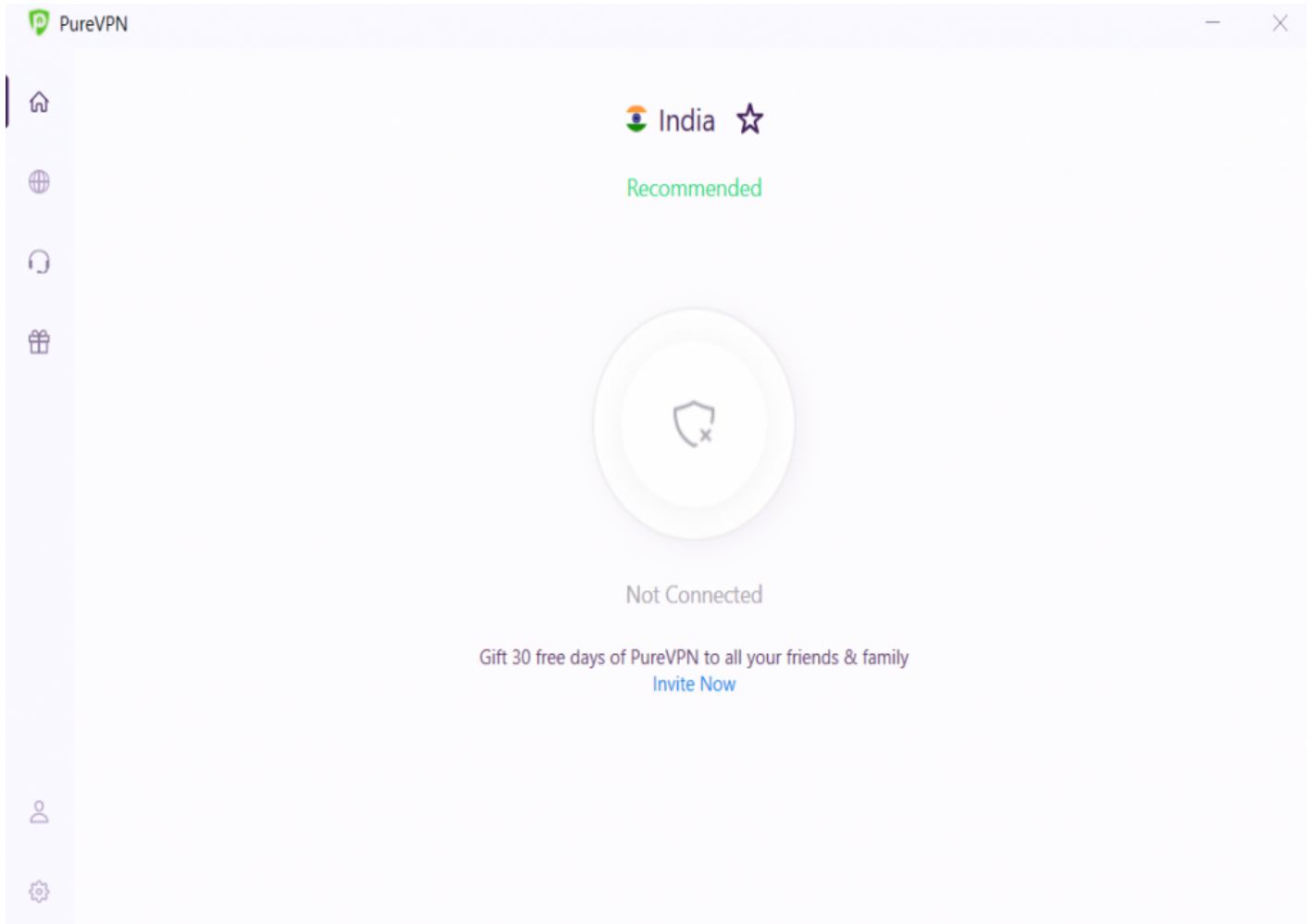

- Select General tab.

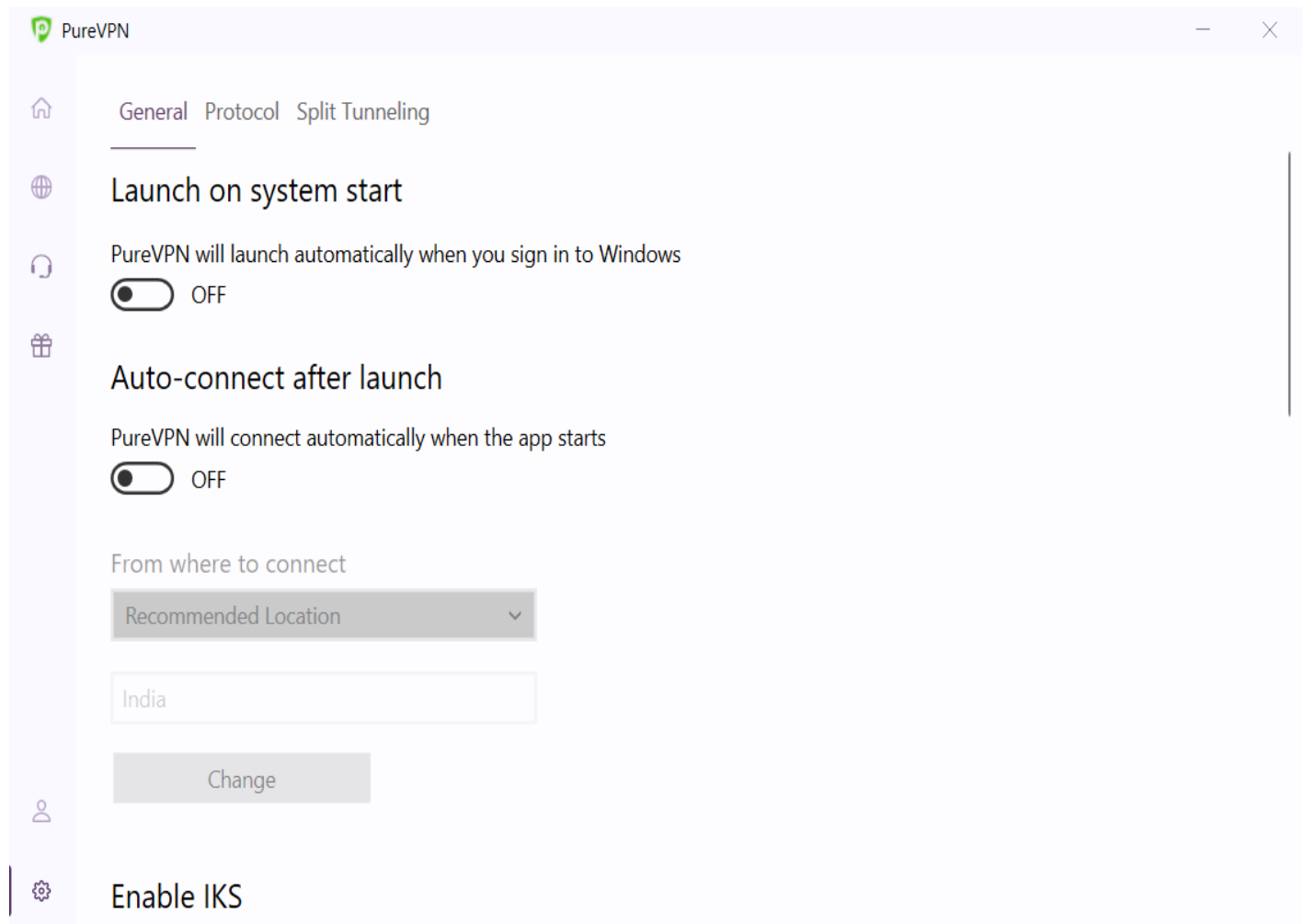

- Toggle Launch on system start & Auto-connect after launch to turn it on.

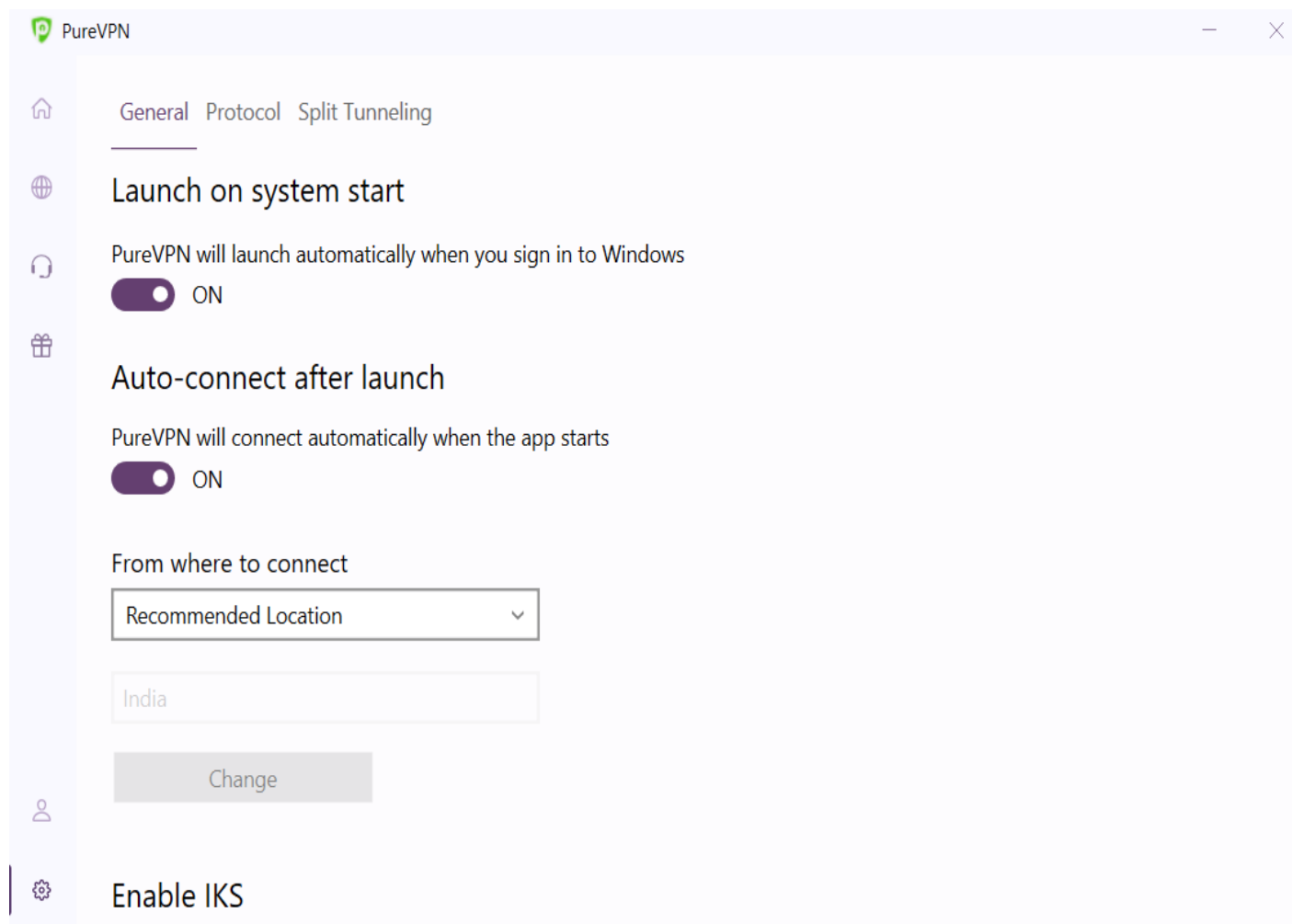

- Once you've enabled the two options, you can select your desired selection from the drop-down list.

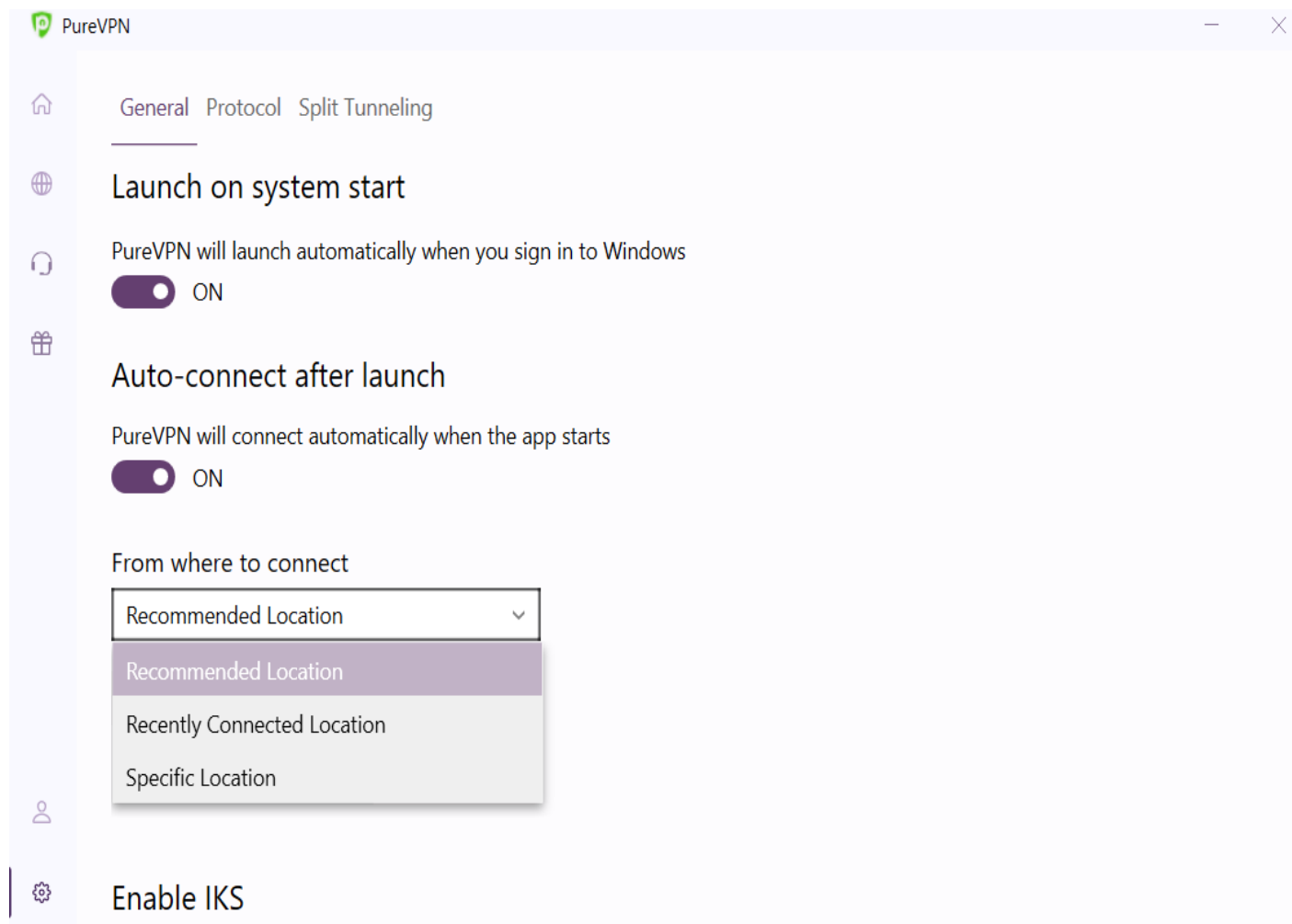

*Note: This won't be applicable if your system is in sleep mode.*

Was this article helpful? Rate and share your comments below. Your input matters to us and everyone else in the Cyber Security Community.